

Le Monolith

Lyon, France

The monolith is a real urban ensemble sited on the C island in the new Conference quarter to the south of the Lyon peninsula between the Saone and the Rhone. The project consists of constructing a 28,000 m² island in the Confluence area of Lyon, with an arrangement of housing, offices and commercial premises.

It is part of the LyonIsland project designed to increase the housing quota in this part of the Lyon peninsula whilst at the same time trying to respect the social mix requirements and new environmental legislation. The monolith is part of the High Environmental Quality building scheme

for residential, office and commercial premises. Compact, and laid out around a central courtyard with access from three monumental doors, five architectural teams each shared a part of the project.

The façades and soffits of the bridge are in Uginox Bright stainless steel which reflected in the garden. The stainless elements are classic blade shapes which interlock one into the other. Industrially produced they are perfectly flat with easy fixing.

From this single volume, each architect found their inventive area and developed one of the parts from the common whole. Our part was essentially made up of offices, laid out in a sculpted voluminous

format to form a huge antagonism above the internal street which looked out onto the large central park as though to absorb it. The façades are clad in Uginox bright mirror sheets. Most of which are crafted to form large helixes which sketch out the imaginary flowers, a reminder of the park on to which the Monolith opens out. The mirror finish allows the multiple reflections of the countryside opposite, lightening the antagonistic roof which fades into the reflections and creating a kaleidoscope area, somewhat imaginary in the middle of this architectural rigour.

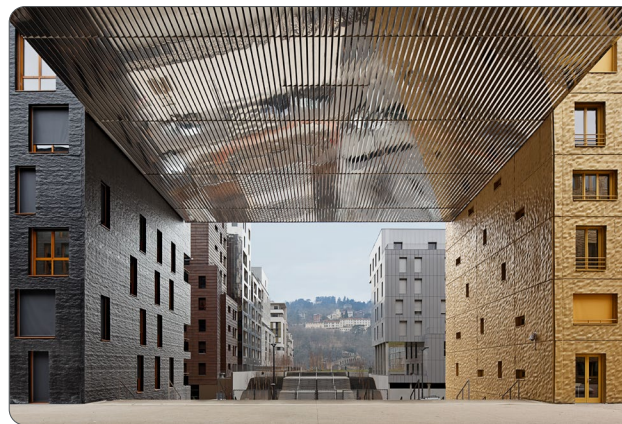

Environment:	urban
Material:	304 Uginox Bright stainless steel with a thickness of 0.8mm
Manufacturer:	Uginox / Aperam
Architects:	Manuelle Gautrand Architecture
Photographs:	Vincent Fillon
More information:	manuelle-gautrand.com or aperam.com



A LOUER
Lieu commercial

A LOUER
Lieu commercial